



[www.gentec.com](http://www.gentec.com)



## PHARMA REGULATORS

(PR20 Series, PR21 Series, PR22 Series, PR23 Series, PR26 Series, PR28 Series, PR29 Series)

*Solutions for Life*



# PROFILE

GENTEC® Company Overview

Solutions for Life



## Company Overview

Genstar Technologies is a global leader in Gas Flow Control Systems for the industrial, specialty gas and medical sectors. We pride ourselves in our ability to provide our customers with high quality, value-added products and services that go beyond the industry standards. As a result, we have a global network of thousands of satisfied customers in over 60 countries.

## Our Team

Our highly educated team of engineers, salespeople, technicians, managers, and customer service personnel are dedicated to providing you with products with the highest quality, reliability and performance. We hold the highest standards to our manufacturing processes; our total process management maximizes our production efficiency while ensuring product quality.

We work closely with all of our customers to design products specific to your needs. This includes developing new products, redesigning existing products, and customizing configuration / packaging. It is our priority to foster a strong relationship with each and every customer.



## Quality Assurance

All of our products are manufactured under stringent quality control. We are ISO 9001:2001, ISO13485, and API certified. Our products meet UL, CE, SEMI, and various international standards and certifications.

## Manufacturing Capabilities

The manufacturing facility is equipped with CNC machines, electro-polishing equipment, and precision automated orbital welding systems, among other features, to ensure the production of the highest quality products.

## Clean Room Facilities

Our class 10/100/1000 clean rooms are designed for Ultra High Purity (UHP) products. UHP products undergo precision machining, surface finishing, electro-polishing and passivation. All UHP products are cleaned by 18MΩ DI water in a cascade ultrasonic tank. To ensure the highest UHP product quality, they are then vacuum-dried and double-bagged.

## PR Series Regulaors

**02-03.** PR20 Series

**04-05.** PR21 Series

**06-07.** PR22 Series

**08-09.** PR23 Series

**10-11.** PR26 Series

**12-13.** PR28 Series

**14-15.** PR29 Series

---

## Accessories

**17.** Clamp Ferrule

**18.** Single Pin Clamp, Gasket

**19.** Solid end Cap, Steel Circular Flanges

**20.** Complete Clamp

# PHARMA REGULATORS

PR20 Series

Solutions for Life

**PR20** series regulator is a single-stage pressure regulators that complies with the USP Class VI and ASME BPE design standards for pharmaceutical manufacturing. It is suitable for applications in the food, biotechnology and pharmaceutical industries.



[▶▶ PR20SLAT-GHW-KC8](#)

## Features

- Diffusion-resistant metal diaphragm seal ensures gas purity and integrity
- Complies with CGA 4.1 and ASTM G93 cleanliness requirements
- Valve body pressure gauge connection: VF4 (1/4 inch VCR female thread)
- Inlet and outlet connections: pharma adaptors, butt weld
- Maximum input pressure: 300 psi
- Maximum outlet pressure: 15 psi, 25 psi, 50 psi, 75 psi, 100 psi, 150 psi
- Safety pressure: 1.5 times the maximum input pressure
- Temperature range: -40°F ~ 165°F (-40°C ~ 74°C)
- CV: 0.15
- Leakage range:  $2 \times 10^{-8}$  atm.cc/sec He
- Wetted surface: Ra 15  $\mu$ m
- Weight: 1.7 kg

## Materials of Construction

- Body: 316L
- Diaphragm: HC22
- Valve Seat: PTFE

## Typical Applications

- Foods
- Pharmaceuticals
- Pharma gas supply

## Dimensions

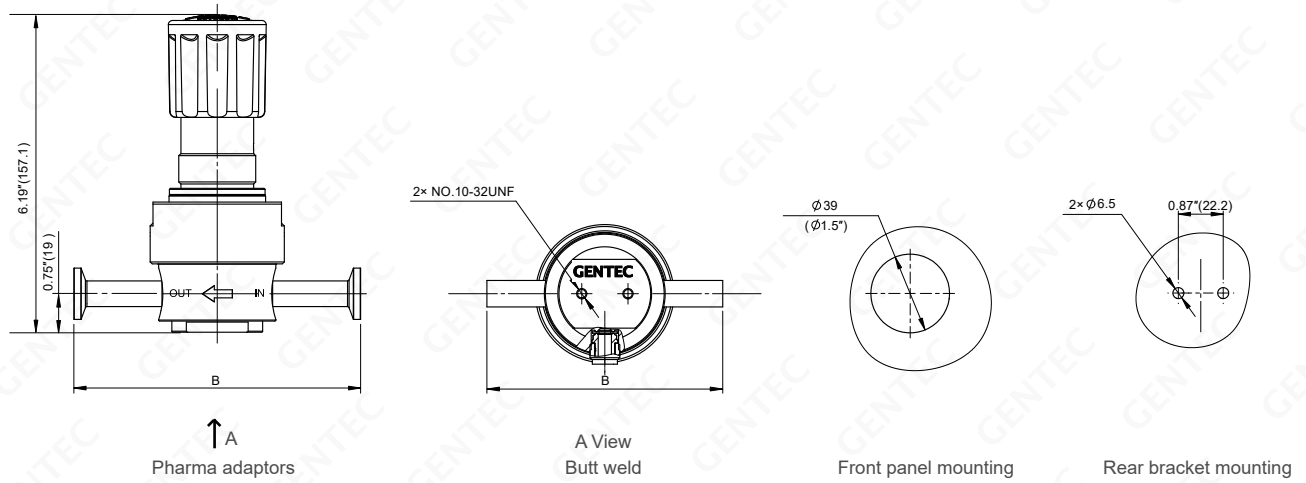

| Specification Code | KC8   | TW6  | TW8  |
|--------------------|-------|------|------|
| $\phi OD$          | 1/2"  | 3/8" | 1/2" |
| $\phi A$           | 25 mm | -    | -    |
| <b>B (mm)</b>      | 142   | 142  | 142  |

Note: According to BS4825 standard

Dimensions: in (mm)

## Flow Data

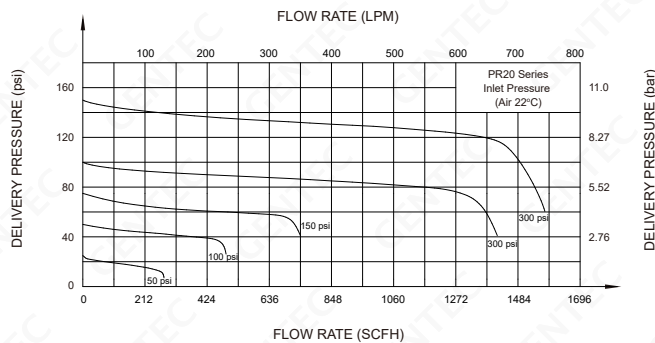

## Body Port



## Ordering Information

| Ex: | PR20SL | A          | T       | - G            | H  | W  | - KC8  | - P               |
|-----|--------|------------|---------|----------------|--|--|--|-------------------|
|     | Series | Body Ports | Seat    | Inlet Pressure | Outlet Pressure  | Gauge  | Inlet / Outlet Connection  | Options           |
|     | PR20SL | A<br>B     | T: PTFE | G: 300 psi     | H: 0 ~ 150 psi<br>I: 0 ~ 100 psi<br>J: 0 ~ 75 psi<br>K: 0 ~ 50 psi<br>L: 0 ~ 25 psi<br>M: 0 ~ 15 psi | W: Without gauges<br>K: psi/kPa<br>P: psi/bar<br>G: MPa<br><br>The standard connection size for the pressure gauge is VSM4 | KC8: 1/2" Pharma adaptor<br>TW6: 3/8" Butt weld<br>TW8: 1/2" Butt weld<br><br>When the inlet and outlet connections are the same, only one connection needs to be written for both connections | P: Panel mounting |

# PHARMA REGULATORS

PR21 Series

Solutions for Life

PR21 series regulator is a single-stage pressure regulators that complies with the USP Class VI and ASME BPE design standards for pharmaceutical manufacturing. It is suitable for applications in the food, biotechnology and pharmaceutical industries.



[▶▶ PR21SLAT-GHW-KC8](#)

## Features

- Diffusion-resistant metal diaphragm seal ensures gas purity and integrity
- Complies with CGA 4.1 and ASTM G93 cleanliness requirements
- Valve body pressure gauge connection: VF4 (1/4 inch VCR female thread)
- Inlet and outlet connections: pharma adaptors, butt weld
- Maximum input pressure: 300 psi
- Maximum outlet pressure: 15 psi, 25 psi, 50 psi, 75 psi, 100 psi, 150 psi
- Safety pressure: 1.5 times the maximum input pressure
- Temperature range: -40°F ~ 165°F (-40°C ~ 74°C)
- CV: 0.24
- Leakage range:  $2 \times 10^{-8}$  atm.cc/sec He
- Wetted surface: Ra 15  $\mu$ m
- Weight: 1.7 kg

## Materials of Construction

- Body: 316L
- Diaphragm: HC22
- Valve Seat: PTFE

## Typical Applications

- Foods
- Pharmaceuticals
- Pharma gas supply

## Dimensions

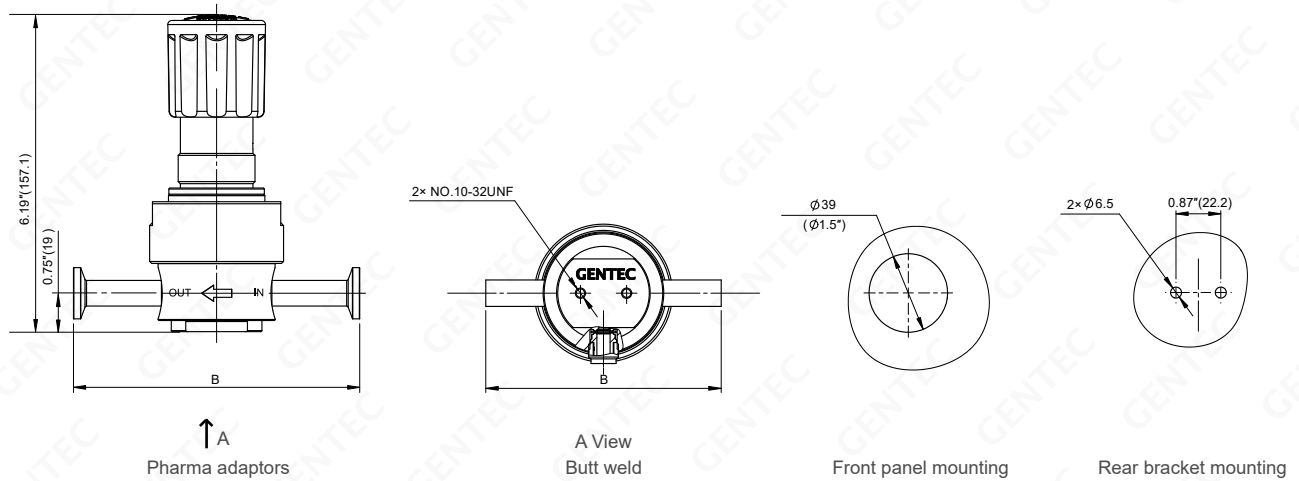

| Specification Code | KC8   | TW6  | TW8  |
|--------------------|-------|------|------|
| $\phi OD$          | 1/2"  | 3/8" | 1/2" |
| $\phi A$           | 25 mm | -    | -    |
| <b>B (mm)</b>      | 142   | 142  | 142  |

Note: According to BS4825 standard

Dimensions: in (mm)

## Flow Data

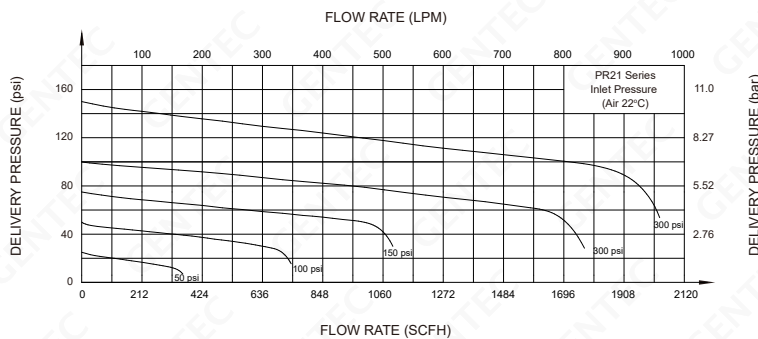

## Body Port



## Ordering Information

| Ex: | PR21SL | A          | T       | - G            | H  | W  | - KC8  | - P               |
|-----|--------|------------|---------|----------------|--|--|--|-------------------|
|     | Series | Body Ports | Seat    | Inlet Pressure | Outlet Pressure  | Gauge  | Inlet / Outlet Connection  | Options           |
|     | PR21SL | A<br>B     | T: PTFE | G: 300 psi     | H: 0 ~ 150 psi<br>I: 0 ~ 100 psi<br>J: 0 ~ 75 psi<br>K: 0 ~ 50 psi<br>L: 0 ~ 25 psi<br>M: 0 ~ 15 psi | W: Without gauges<br>K: psi/kPa<br>P: psi/bar<br>G: MPa<br><br>The standard connection size for the pressure gauge is VSM4 | KC8: 1/2" Pharma adaptor<br>TW6: 3/8" Butt weld<br>TW8: 1/2" Butt weld<br><br>When the inlet and outlet connections are the same, only one connection needs to be written for both connections | P: Panel mounting |

# PHARMA REGULATORS

PR22 Series

Solutions for Life

PR22 series regulator is a high-purity, high-flow, single-stage pressure regulators that complies with the USP Class VI and ASME BPE design standards for pharmaceutical manufacturing. It is suitable for applications in the food, biotechnology and pharmaceutical industries.



» PR22SLAT-GIW-KC12B

## Features

- Single-stage balanced pressure reduction structure
- Complies with CGA 4.1 and ASTM G93 cleanliness requirements
- Valve body pressure gauge connection: VF4 (1/4 inch VCR female thread)
- Inlet and outlet connections: pharma adaptors, butt weld
- Maximum input pressure: 500 psi
- Maximum outlet pressure: 25 psi, 50 psi, 75 psi, 100 psi, 150 psi
- Safety pressure: 1.5 times the maximum input pressure
- Temperature range: -40°F ~ 165°F (-40°C ~ 74°C)
- CV: 1.0
- Leakage range:  $2 \times 10^{-8}$  atm.cc/sec He
- Wetted surface: Ra 15  $\mu$ m
- Weight: 2.3 kg

## Materials of Construction

- Body: 316L
- O-Ring: EPDM
- Diaphragm: HC22
- Valve Seat: PTFE

## Typical Applications

- Foods
- Pharmaceuticals
- Pharma gas supply



## Dimensions

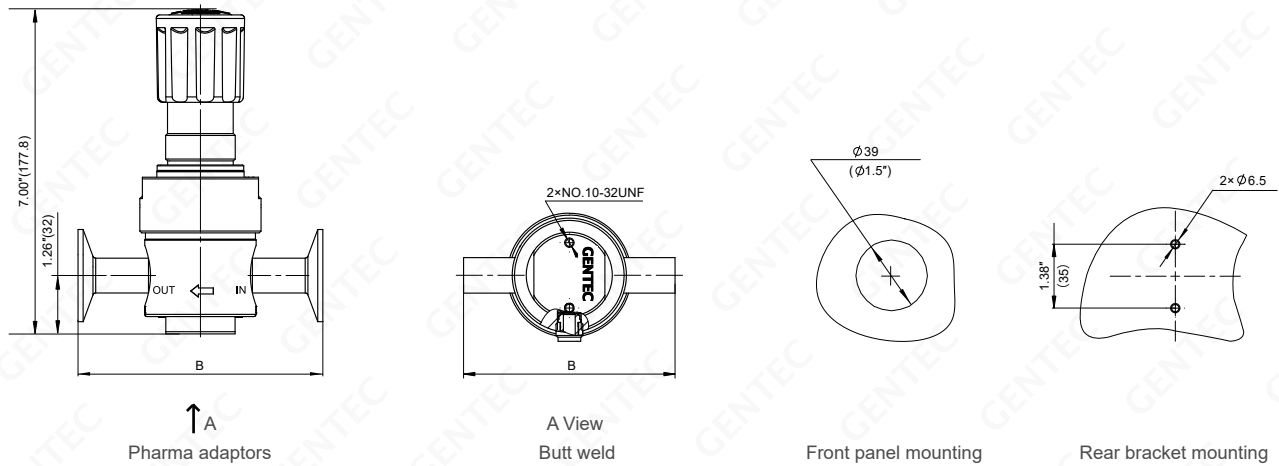

| Specification Code | KC8       | KC12    | TW8  | TW12 |
|--------------------|-----------|---------|------|------|
|                    | $\phi OD$ | 1/2"    | 3/4" | 1/2" |
| $\phi A$           | 25.4 mm   | 25.4 mm | -    | -    |
| <b>B (mm)</b>      | 113.2     | 113.2   | 120  | 120  |

Note: According to BS4825 standard

Dimensions: in (mm)

## Flow Data

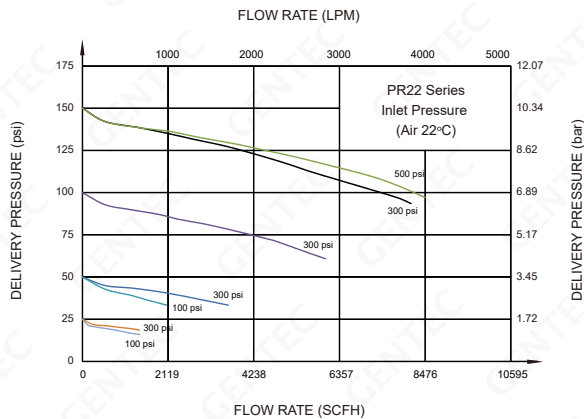

## Body Port



## Ordering Information

| Ex: PR22SL | B          | T       | - G                      | I   | W  | - KC8  | - P               |
|------------|------------|---------|--------------------------|---|--|--|-------------------|
| Series     | Body Ports | Seat    | Inlet Pressure           | Outlet Pressure   | Gauge  | Inlet / Outlet Connection  | Options           |
| PR22SL     | A<br>B     | T: PTFE | F: 500 psi<br>G: 300 psi | H: 0 ~ 150 psi<br>I: 0 ~ 100 psi<br>J: 0 ~ 75 psi<br>K: 0 ~ 50 psi<br>L: 0 ~ 25 psi | W: Without gauges<br>K: psi/kPa<br>P: psi/bar<br>G: MPa<br><br>The standard connection size for the pressure gauge is VSM4 | KC8: 1/2" Pharma adaptor<br>KC12: 3/4" Pharma adaptor<br>TW8: 1/2" Butt weld<br>TW12: 3/4" Butt weld<br><br>When the inlet and outlet connections are the same, only one connection needs to be written for both connections | P: Panel mounting |

# PHARMA REGULATORS

PR23 Series

Solutions for Life

**PR23** series regulator is a high-purity, high-flow, single-stage pressure regulators that complies with the USP Class VI and ASME BPE design standards for pharmaceutical manufacturing. It is suitable for applications in the food, biotechnology and pharmaceutical industries.



[▶▶ PR23SLAT-GIW-KC12B](#)

## Features

- Single-stage balanced pressure reduction structure
- Complies with CGA 4.1 and ASTM G93 cleanliness requirements
- Valve body pressure gauge connection: VF4 (1/4 inch VCR female thread)
- Inlet and outlet connections: pharma adaptors, butt weld, flanges
- Maximum input pressure: 500 psi
- Maximum outlet pressure: 25 psi, 50 psi, 75 psi, 100 psi, 150 psi
- Safety pressure: 1.5 times the maximum input pressure
- Temperature range: -40°F ~ 165°F (-40°C ~ 74°C)
- CV: 1.8
- Leakage range:  $2 \times 10^{-8}$  atm.cc/sec He
- Wetted surface: Ra 15  $\mu$ m
- Weight: 2.55 kg

## Materials of Construction

- Body: 316L
- O-Ring: EPDM
- Diaphragm: HC22
- Valve Seat: PTFE

## Typical Applications

- Foods
- Pharmaceuticals
- Pharma gas supply

## Dimensions

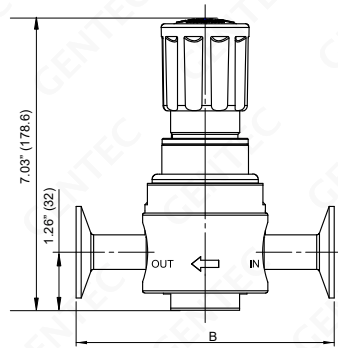

↑ A  
Pharma adaptors

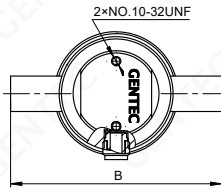

A View  
Butt weld

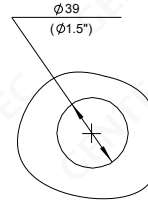

Front panel mounting

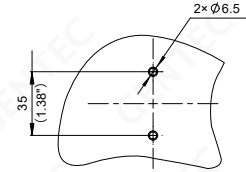

Rear bracket mounting

| Specification Code | KC8       | KC12    | TW8  | TW12 |
|--------------------|-----------|---------|------|------|
|                    | $\phi OD$ | 1/2"    | 3/4" | 1/2" |
| $\phi A$           | 25.4 mm   | 25.4 mm | -    | -    |
| <b>B (mm)</b>      | 121.2     | 121.2   | 120  | 120  |

Note: According to BS4825 standard

Dimensions: in (mm)

## Flow Data

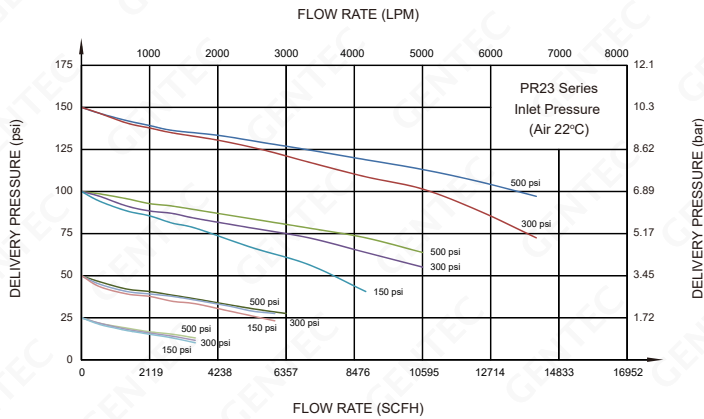

## Body Port



## Ordering Information

| Ex: PR23SL | B          | T       | - G                      | I   | W  | - KC8  | - P               |
|------------|------------|---------|--------------------------|---|--|--|-------------------|
| Series     | Body Ports | Seat    | Inlet Pressure           | Outlet Pressure   | Gauge  | Inlet / Outlet Connection  | Options           |
| PR23SL     | A<br>B     | T: PTFE | F: 500 psi<br>G: 300 psi | H: 0 ~ 150 psi<br>I: 0 ~ 100 psi<br>J: 0 ~ 75 psi<br>K: 0 ~ 50 psi<br>L: 0 ~ 25 psi | W: Without gauges<br>K: psi/kPa<br>P: psi/bar<br>G: MPa<br><br>The standard connection size for the pressure gauge is VSM4 | KC8: 1/2" Pharma adaptor<br>KC12: 3/4" Pharma adaptor<br>DN20: DN20 Flanges<br>DN25: DN25 Flanges<br>TW8: 1/2" Butt weld<br>TW12: 3/4" Butt weld<br><br>When the inlet and outlet connections are the same, only one connection needs to be written for both connections | P: Panel mounting |

# PHARMA REGULATORS

PR26 Series

Solutions for Life

PR26 series regulator is a diaphragm pressure regulators that complies with the USP Class VI and ASME BPE design standards for pharmaceutical manufacturing. It is suitable for applications in the food, biotechnology and pharmaceutical industries.



▶▶ PR26SLAY-FGW-KC16

## Features

- Single-stage pressure reduction structure
- Complies with CGA 4.1 and ASTM G93 cleanliness requirements
- Valve body pressure gauge connection: VF4 (1/4 inch VCR female thread)
- Inlet and outlet connections: pharma adaptors, butt weld, flanges
- Maximum input pressure: 300 psi
- Maximum outlet pressure: 25 psi, 50 psi, 75 psi, 100 psi, 150 psi, 250 psi
- Safety pressure: 1.5 times the maximum input pressure
- Temperature range: -40°F ~ 300°F (-40°C ~ 149°C)
- CV: 5.0
- Leakage range:  $2 \times 10^{-8}$  atm.cc/sec He
- Wetted surface: Ra 15  $\mu$ m
- Weight: 5.7 kg

## Materials of Construction

- Body: 316L
- Diaphragm: EPDM
- Valve Seat: EPDM

## Typical Applications

- Foods
- Pharmaceuticals
- Pharma gas supply

## Dimensions

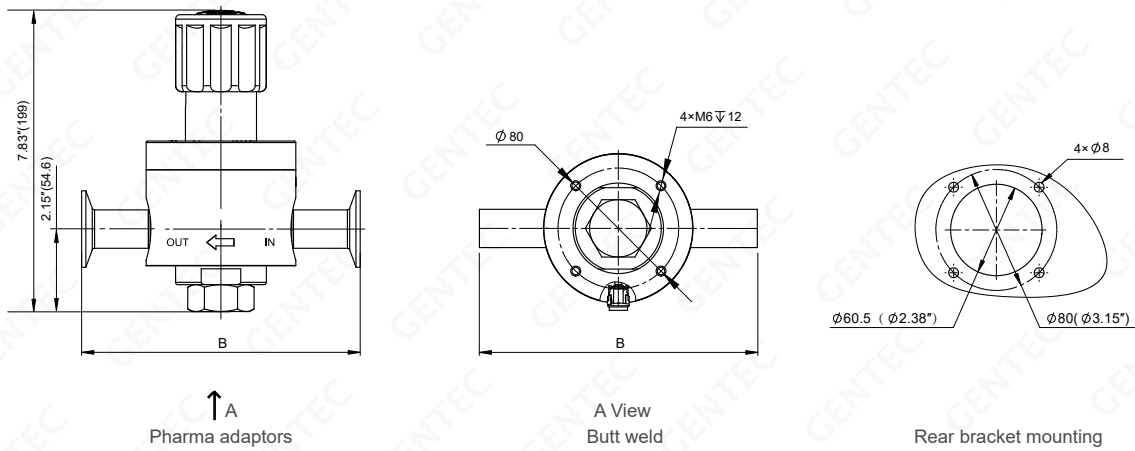

| Specification Code | KC12  | KC16    | KC20D    | KC25D    | TW12  | TW16  |
|--------------------|-------|---------|----------|----------|-------|-------|
| $\phi OD$          | 3/4"  | 1"      | ISO DN20 | ISO DN25 | 3/4"  | 1"    |
| $\phi A$           | 25 mm | 50.4 mm | 50.4 mm  | 50.4 mm  | -     | -     |
| <b>B (mm)</b>      | 184.2 | 184.2   | 184.2    | 184.2    | 251.7 | 251.7 |

Note: According to BS4825 standard and ISO2852 standard

Dimensions: in (mm)

## Flow Data

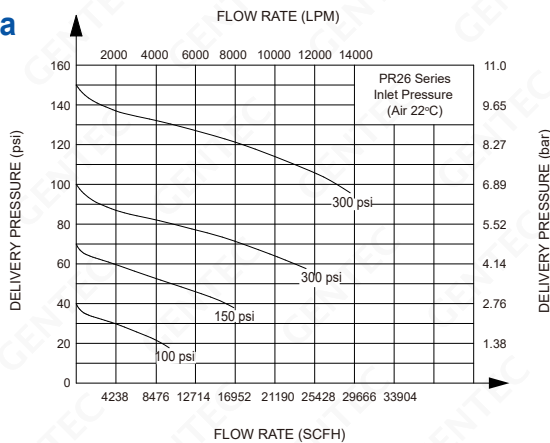

## Body Port



## Ordering Information

| Ex: PR26SL | A          | Y       | - G            | G   | W  | - KC16   |
|------------|------------|---------|----------------|---|--|--|
| Series     | Body Ports | Seat    | Inlet Pressure | Outlet Pressure   | Gauge  | Inlet / Outlet Connection  |
| PR26SL     | A<br>B     | Y: EPDM | G: 300 psi     | G: 0 ~ 250 psi<br>H: 0 ~ 150 psi<br>I: 0 ~ 100 psi<br>J: 0 ~ 75 psi<br>K: 0 ~ 50 psi<br>L: 0 ~ 25 psi | W: Without gauges<br>K: psi/kPa<br>P: psi/bar<br>G: MPa<br><br>The standard connection size for the pressure gauge is VSM4 | KC12: 3/4" Pharma adaptor (BS4825)<br>KC16: 1" Pharma adaptor (BS4825)<br>KC20D: DN20 Pharma adaptor (ISO2852)<br>KC25D: DN25 Pharma adaptor (ISO2852)<br>DN20: DN20 Flanges (DIN EN1092-1)<br>DN25: DN25 Flanges (DIN EN1092-1)<br>TW12: 3/4" Butt weld<br>TW16: 1" Butt weld<br><br>When the inlet and outlet connections are the same, only one connection needs to be written for both connections |

# PHARMA REGULATORS

PR28 Series

Solutions for Life

PR28 series regulator is a diaphragm pressure regulators that complies with the USP Class VI and ASME BPE design standards for pharmaceutical manufacturing. It is suitable for applications in the food, biotechnology and pharmaceutical industries.



▶▶ PR28SLAY-FGW-KC24

## Features

- Single-stage pressure reduction structure
- Complies with CGA 4.1 and ASTM G93 cleanliness requirements
- Valve body pressure gauge connection: VF4 (1/4 inch VCR female thread)
- Inlet and outlet connections: pharma adaptors, butt weld, flanges
- Maximum input pressure: 300 psi
- Maximum outlet pressure: 25 psi, 50 psi, 75 psi, 100 psi, 150 psi, 250 psi
- Safety pressure: 1.5 times the maximum input pressure
- Temperature range: -40°F ~ 300°F (-40°C ~ 149°C)
- CV: 10.0
- Leakage range:  $2 \times 10^{-8}$  atm.cc/sec He
- Wetted surface: Ra 15  $\mu$ m
- Weight: 6.7 kg

## Materials of Construction

- Body: 316L
- O-ring: EPDM
- Diaphragm: PTFE
- Valve Seat: EPDM

## Typical Applications

- Foods
- Pharmaceuticals
- Pharma gas supply

## Dimensions

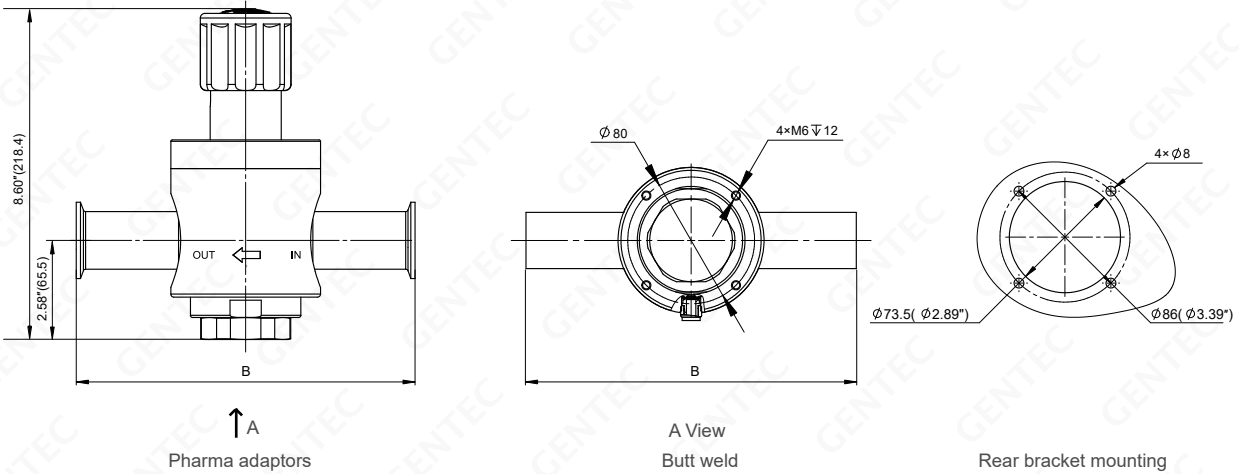

| Specification Code | KC16    | KC24    | KC20D    | KC25D    | TW16  | TW24  |
|--------------------|---------|---------|----------|----------|-------|-------|
| $\phi$ OD          | 1"      | 1.5"    | ISO DN20 | ISO DN25 | 1"    | 1.5"  |
| $\phi$ A           | 50.4 mm | 50.4 mm | 50.4 mm  | 50.4 mm  | -     | -     |
| B (mm)             | 224     | 224     | 224      | 224      | 251.7 | 251.7 |

Note: According to BS4825 standard and ISO2852 standard

Dimensions: in (mm)

## Flow Data

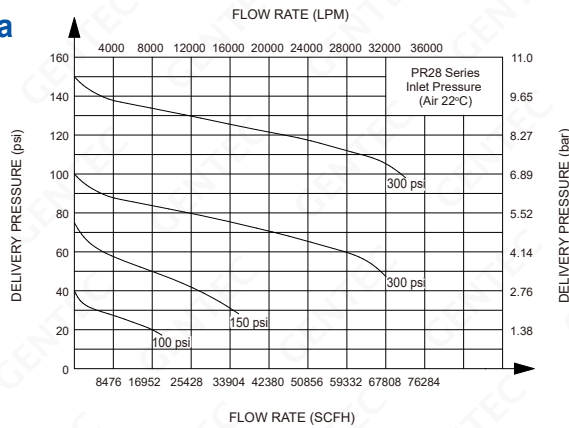

## Body Port



## Ordering Information

| Ex: PR28SL | A          | Y       | - G            | G   | W  | - KC24  |
|------------|------------|---------|----------------|---|--|---|
| Series     | Body Ports | Seat    | Inlet Pressure | Outlet Pressure   | Gauge  | Inlet / Outlet Connection   |
| PR28SL     | A<br>B     | Y: EPDM | G: 300 psi     | G: 0 ~ 250 psi<br>H: 0 ~ 150 psi<br>I: 0 ~ 100 psi<br>J: 0 ~ 75 psi<br>K: 0 ~ 50 psi<br>L: 0 ~ 25 psi | W: Without gauges<br>K: psi/kPa<br>P: psi/bar<br>G: MPa<br><br>The standard connection size for the pressure gauge is VSM4 | KC16: 1" Pharma adaptor (BS4825)<br>KC24: 1.5" Pharma adaptor (BS4825)<br>KC20D: DN20 Pharma adaptor (ISO2852)<br>KC25D: DN25 Pharma adaptor (ISO2852)<br>DN32: DN32 Flanges (DIN EN1092-1)<br>DN40: DN40 Flanges (DIN EN1092-1)<br>DN50: DN50 Flanges (DIN EN1092-1)<br>TW16: 1" Butt weld<br>TW24: 1.5" Butt weld<br><br>When the inlet and outlet connections are the same, only one connection needs to be written for both connections |

# PHARMA REGULATORS

PR29 Series

Solutions for Life

**PR29** series regulator is a high-purity, high-flow, single-stage diaphragm pressure regulators that complies with the USP Class VI and ASME BPE design standards for pharmaceutical manufacturing. It is suitable for applications in the food, biotechnology and pharmaceutical industries.



▶▶ PR29SLAY-GIW-KC16

## Features

- Single-stage balanced pressure reduction structure
- Complies with CGA 4.1 and ASTM G93 cleanliness requirements
- Valve body pressure gauge connection: VF4 (1/4 inch VCR female thread)
- Inlet and outlet connections: pharma adaptors, butt weld, flanges
- Maximum input pressure: 300 psi
- Maximum outlet pressure: 25 psi, 50 psi, 75 psi, 100 psi, 150 psi, 250 psi
- Safety pressure: 1.5 times the maximum input pressure
- Temperature range: -20°F ~ 300°F (-29°C ~ 149°C)
- CV: 10.0
- Leakage range:  $2 \times 10^{-8}$  atm.cc/sec He
- Wetted surface: Ra 15  $\mu$ m
- Weight: 15.5 kg

## Materials of Construction

- Body: 316L
- O-ring: EPDM
- Diaphragm: PTFE
- Valve Seat: EPDM

## Typical Applications

- Foods
- Pharmaceuticals
- Pharma gas supply



## Dimensions

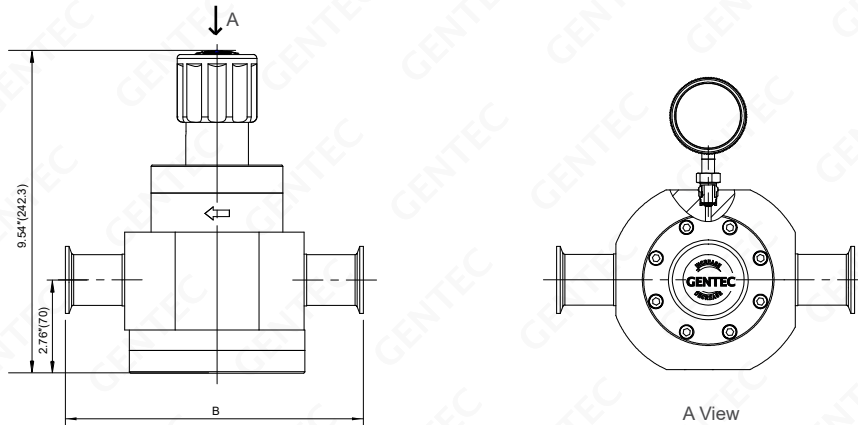

| Specification Code | KC16    | KC24    | KC32  | KC20D    | KC25D    | KC32D    | KC40D    | TW16  | TW24  |
|--------------------|---------|---------|-------|----------|----------|----------|----------|-------|-------|
| $\phi$ OD          | 1"      | 1.5"    | 2"    | ISO DN20 | ISO DN25 | ISO DN32 | ISO DN40 | 1"    | 1.5"  |
| $\phi$ A           | 50.4 mm | 50.4 mm | 64 mm | 50.4 mm  | 50.4 mm  | 50.4 mm  | 64 mm    | -     | -     |
| B (mm)             | 224     | 224     | 218   | 224      | 224      | 224      | 218      | 293.6 | 293.6 |

Note: According to BS4825 standard and ISO2852 standard

Dimensions: in (mm)

## Flow Data

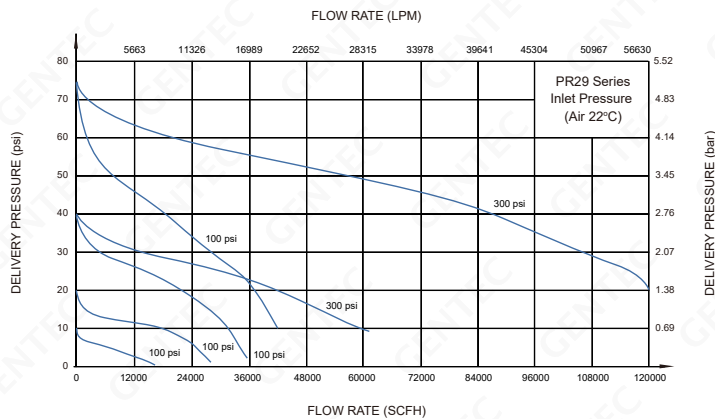

## Body Port



## Ordering Information

| Ex: PR29SL | A          | Y       | - G            | I   | W  | - KC16  |
|------------|------------|---------|----------------|---|--|---|
| Series     | Body Ports | Seat    | Inlet Pressure | Outlet Pressure   | Gauge  | Inlet / Outlet Connection   |
| PR29SL     | A<br>B     | Y: EPDM | G: 300 psi     | G: 0 ~ 250 psi<br>H: 0 ~ 150 psi<br>I: 0 ~ 100 psi<br>J: 0 ~ 75 psi<br>K: 0 ~ 50 psi<br>L: 0 ~ 25 psi | W: Without gauges<br>K: psi/kPa<br>P: psi/bar<br>G: MPa<br><br>The standard connection size for the pressure gauge is VSM4 | KC16: 1" Pharma adaptor (BS4825)<br>KC24: 1.5" Pharma adaptor (BS4825)<br>KC32: 2" Pharma adaptor (BS4825)<br>KC20D: DN20 Pharma adaptor (ISO2852)<br>KC25D: DN25 Pharma adaptor (ISO2852)<br>KC32D: DN32 Pharma adaptor (ISO2852)<br>KC40D: DN40 Pharma adaptor (ISO2852)<br>DN32: DN32 Flanges (DIN EN1092-1)<br>DN40: DN40 Flanges (DIN EN1092-1)<br>DN50: DN50 Flanges (DIN EN1092-1)<br>TW16: 1" Butt weld<br>TW24: 1.5" Butt weld<br><br>When the inlet and outlet connections are the same, only one connection needs to be written for both connections |

# ACCESSORIES

Solutions for Life

GENTEC® Clamps, ferrules, gaskets, caps, and flanges meet stringent requirements of the food, chemical and pharmaceutical industries. These accessories can be provided as a set or as individual component(s) according to customer requirements.



Example 1



Example 2

## Clamp Ferrule (BS4825)

According to BS4825/ASME BPE 2022 standard.

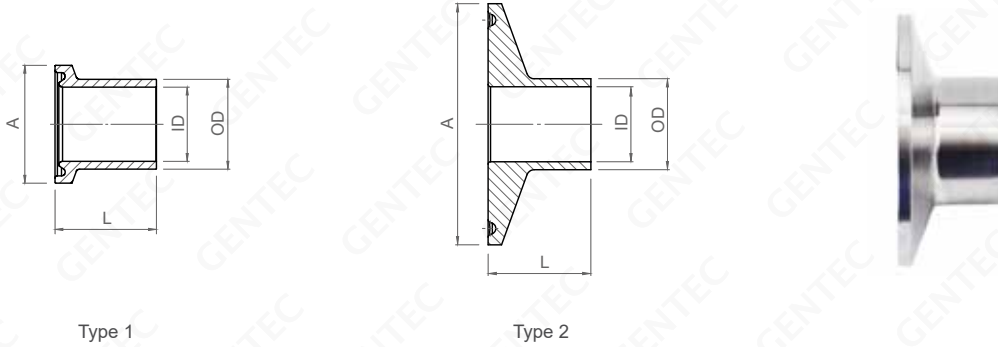

| Standard | Model No.      | Specification |        | φOD (mm) | φID (mm) | φA (mm) | L (mm) | Applicable Flanges |
|----------|----------------|---------------|--------|----------|----------|---------|--------|--------------------|
|          |                | Size          | Type   |          |          |         |        |                    |
| BS4825   | SL-KC8-28.6    | 1/2"          | Type 1 | 12.7     | 9.4      | 25      | 28.6   | KC8                |
|          | SL-KC12-28.6   | 3/4"          | Type 1 | 19.05    | 15.75    | 25      | 28.6   | KC12               |
|          | SL-KC8B-28.6*  | 1/2"          | Type 2 | 12.7     | 9.4      | 50.4    | 28.6   | KC8B               |
|          | SL-KC12B-28.6* | 3/4"          | Type 2 | 19.05    | 15.75    | 50.4    | 28.6   | KC12B              |
|          | SL-KC16-28.6   | 1"            | Type 2 | 25.4     | 22.1     | 50.4    | 28.6   | KC16               |
|          | SL-KC24-28.6   | 1.5"          | Type 2 | 38.1     | 34.8     | 50.4    | 28.6   | KC24               |
|          | SL-KC32-28.6   | 2"            | Type 2 | 50.8     | 47.5     | 64      | 28.6   | KC32               |

Note: 1. \* indicates non-standard products, please contact Gentec for more information

## Clamp Ferrule (ISO2852)

According to ISO 2852 standard, the tube size is according to ISO 1127 standard.



| Standard | Model No.     | Size     | φOD (mm) | φID (mm) | φA (mm) | L (mm) | Applicable Flanges |
|----------|---------------|----------|----------|----------|---------|--------|--------------------|
| ISO2852  | SL-KC10D-28.6 | ISO DN10 | 17.2     | 14       | 34      | 28.6   | KC10D              |
|          | SL-KC15D-28.6 | ISO DN15 | 21.3     | 18.1     | 34      | 28.6   | KC15D              |
|          | SL-KC20D-28.6 | ISO DN20 | 26.9     | 23.7     | 50.4    | 28.6   | KC20D              |
|          | SL-KC25D-28.6 | ISO DN25 | 33.7     | 30.5     | 50.4    | 28.6   | KC25D              |
|          | SL-KC32D-28.6 | ISO DN32 | 42.4     | 39.2     | 50.4    | 28.6   | KC32D              |
|          | SL-KC40D-28.6 | ISO DN40 | 48.3     | 45.1     | 64      | 28.6   | KC40D              |
|          | SL-KC50D-28.6 | ISO DN50 | 60.3     | 56.3     | 77.4    | 28.6   | KC50D              |
|          | SL-KC65D-28.6 | ISO DN65 | 76.2     | 72.2     | 91      | 28.6   | KC60D              |

# ACCESSORIES

Single Pin Clamp, Gasket

Solutions for Life

## Single Pin Clamp

304 grade stainless steel clamps are designed to BS4825 standards and ISO 2852.



| Model No. | Size     | ΦA (mm) | ΦB (mm) | Flange outer diameter Φ (mm) | Applicable Flanges |
|-----------|----------|---------|---------|------------------------------|--------------------|
| SS-KK-25  | 1/2"     | 21.2    | 28.2    | 25                           | KC8                |
|           | 3/4"     |         |         |                              | KC12               |
| SS-KK-34  | ISO DN10 | 27.8    | 37      | 34                           | KC10D              |
|           | ISO DN15 |         |         |                              | KC15D              |
|           | ISO DN20 |         |         |                              | KC20D              |
| SS-KK-50  | 1/2"     | 44.4    | 53.6    | 50.4                         | KC8B               |
|           | 3/4"     |         |         |                              | KC12B              |
|           | 1"       |         |         |                              | KC16               |
|           | 1.5"     |         |         |                              | KC24               |
|           | ISO DN25 |         |         |                              | KC25D              |
| SS-KK-64  | 2"       | 57.8    | 67      | 64                           | KC32               |
|           | ISO DN40 |         |         |                              | KC40D              |
| SS-KK-77  | ISO DN50 | 71.4    | 80.6    | 77.4                         | KC50D              |
| SS-KK-91  | ISO DN65 | 84      | 94.2    | 91                           | KC65D              |

## Gasket

EPDM seals are designed to BS4825 standards and ISO 2852.

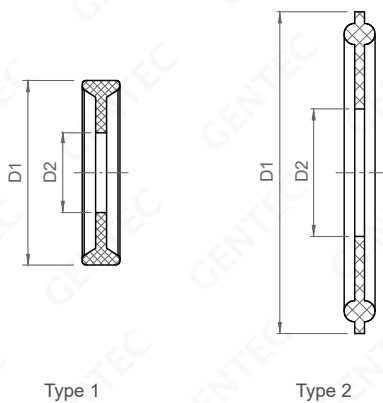

| Model No.      | Specification |        | ΦD1 (mm) | ΦD2 (mm) | Applicable Flanges |
|----------------|---------------|--------|----------|----------|--------------------|
|                | Size          | Type   |          |          |                    |
| EPDM-KD-KC8    | 1/2"          | Type 1 | 22       | 9.5      | KC8                |
| EPDM-KD-KC12   | 3/4"          | Type 1 | 22       | 15.9     | KC12               |
| EPDM-KD-KC8B*  | 1/2"          | Type 2 | 50.4     | 9.5      | KC8B               |
| EPDM-KD-KC12B* | 3/4"          | Type 2 | 50.4     | 15.9     | KC12B              |
| EPDM-KD-KC16   | 1"            | Type 2 | 50.4     | 22.2     | KC16               |
| EPDM-KD-KC24   | 1.5"          | Type 2 | 50.4     | 35       | KC24               |
| EPDM-KD-KC32   | 2"            | Type 2 | 64       | 47.7     | KC32               |
| EPDM-KD-KC10D  | ISO DN10      | Type 2 | 34       | 14.1     | KC10D              |
| EPDM-KD-KC15D  | ISO DN15      | Type 2 | 34       | 18.2     | KC15D              |
| EPDM-KD-KC20D  | ISO DN20      | Type 2 | 50.4     | 23.8     | KC20D              |
| EPDM-KD-KC25D  | ISO DN25      | Type 2 | 50.4     | 30.7     | KC25D              |
| EPDM-KD-KC32D  | ISO DN32      | Type 2 | 50.4     | 39.4     | KC32D              |
| EPDM-KD-KC40D  | ISO DN40      | Type 2 | 64       | 45.3     | KC40D              |
| EPDM-KD-KC50D  | ISO DN50      | Type 2 | 77.4     | 56.5     | KC50D              |
| EPDM-KD-KC65D  | ISO DN65      | Type 2 | 91       | 72.4     | KC65D              |

Note: 1. \* indicates non-standard products, please contact Gentec for more information

2. For other materials such as FKM, PTFE, please contact Gentec for more information

## Solid End Cap

Constructed from 304 grade stainless steel.

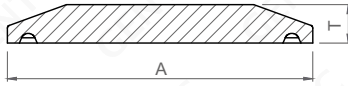

| Model No.       | Size     | ΦA (mm) | T (mm) | Applicable Flanges |
|-----------------|----------|---------|--------|--------------------|
| <b>SS-KG-25</b> | 1/2"     | 21.2    | 28.2   | KC8                |
|                 | 3/4"     |         |        | KC12               |
|                 | ISO DN10 | 27.8    | 37     | KC10D              |
| <b>SS-KG-50</b> | 1"       | 50.4    | 6.35   | KC16               |
|                 | 1.5"     |         |        | KC25               |
|                 | ISO DN15 | 50.4    | 6.35   | KC15D              |
|                 | ISO DN20 |         |        | KC20D              |
| ISO DN25        |          |         | KC25D  |                    |
| <b>SS-KG-64</b> | 2"       | 64      | 6.35   | KC32               |
|                 | ISO DN32 |         |        | KC32D              |
|                 | ISO DN40 |         |        | KC40D              |
| <b>SS-KG-77</b> | ISO DN50 | 77.4    | 6.35   | KC50D              |
| <b>SS-KG-91</b> | ISO DN65 | 91      | 6.35   | KC65D              |

## DIN EN 1092-1 Steel Circular Flanges

Designed to meet DIN EN 1092-1 TYPE11 standard and DIN EN 558 standards.

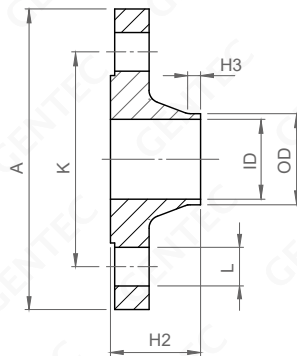

| Standard             | Model No.         | Size | ΦA (mm) | H2 (mm) | H3 (mm) | ΦID (mm) | ΦOD (mm) | ΦK (mm) | ΦL (mm) |
|----------------------|-------------------|------|---------|---------|---------|----------|----------|---------|---------|
| <b>DIN EN 1092-1</b> | <b>SL-FL DN20</b> | DN20 | 105     | 40      | 6       | 22.3     | 26.9     | 75      | 4 × φ14 |
|                      | <b>SL-FL DN25</b> | DN25 | 115     | 40      | 6       | 28.5     | 33.7     | 85      | 4 × φ14 |
|                      | <b>SL-FL DN32</b> | DN32 | 140     | 42      | 6       | 37.2     | 42.4     | 100     | 4 × φ18 |
|                      | <b>SL-FL DN40</b> | DN40 | 150     | 45      | 7       | 43.1     | 48.3     | 110     | 4 × φ18 |
|                      | <b>SL-FL DN50</b> | DN50 | 165     | 48      | 8       | 54.5     | 60.3     | 125     | 4 × φ18 |

# ACCESSORIES

Example

Solutions for Life

## Complete Clamp



| Model No.          | Clamp fittings (BS4825) Size | Clamp Connector (ISO 2852) Size | Single pin clamp Size | Clamp Washer Size | Cap Size |
|--------------------|------------------------------|---------------------------------|-----------------------|-------------------|----------|
| <b>KITS-KC8</b>    | SL-KC8-28.6                  | -                               | SS-KK-25              | EPDM-KD-KC8       | SS-KG-25 |
| <b>KITS-KC8B*</b>  | SL-KC8B-28.6                 | -                               | SS-KK-50              | EPDM-KD-KC8B      | SS-KG-50 |
| <b>KITS-KC12</b>   | SL-KC12-28.6                 | -                               | SS-KK-25              | EPDM-KD-KC12      | SS-KG-25 |
| <b>KITS-KC12B*</b> | SL-KC12B-28.6                | -                               | SS-KK-50              | EPDM-KD-KC12B     | SS-KG-50 |
| <b>KITS-KC16</b>   | SL-KC16-28.6                 | -                               | SS-KK-50              | EPDM-KD-KC16      | SS-KG-50 |
| <b>KITS-KC24</b>   | SL-KC24-28.6                 | -                               | SS-KK-50              | EPDM-KD-KC24      | SS-KG-50 |
| <b>KITS-KC32</b>   | SL-KC32-28.6                 | -                               | SS-KK-64              | EPDM-KD-KC32      | SS-KG-64 |
| <b>KITS-KC10D</b>  | -                            | SL-KC10D-28.6                   | SS-KK-25              | EPDM-KD-KC10D     | SS-KG-25 |
| <b>KITS-KC15D</b>  | -                            | SL-KC15D-28.6                   | SS-KK-25              | EPDM-KD-KC15D     | SS-KG-25 |
| <b>KITS-KC20D</b>  | -                            | SL-KC20D-28.6                   | SS-KK-25              | EPDM-KD-KC20D     | SS-KG-25 |
| <b>KITS-KC25D</b>  | -                            | SL-KC25D-28.6                   | SS-KK-50              | EPDM-KD-KC25D     | SS-KG-50 |
| <b>KITS-KC32D</b>  | -                            | SL-KC32D-28.6                   | SS-KK-50              | EPDM-KD-KC32D     | SS-KG-50 |
| <b>KITS-KC40D</b>  | -                            | SL-KC40D-28.6                   | SS-KK-64              | EPDM-KD-KC40D     | SS-KG-64 |
| <b>KITS-KC50D</b>  | -                            | SL-KC50D-28.6                   | SS-KK-77              | EPDM-KD-KC50D     | SS-KG-77 |
| <b>KITS-KC65D</b>  | -                            | SL-KC65D-28.6                   | SS-KK-91              | EPDM-KD-KC65D     | SS-KG-91 |

- Note: 1. \* indicates non-standard products, please contact Gentec for more information  
 2. For other gasket materials such as FKM, PTFE, please contact Gentec for more information  
 3. The solid end cap is an optional



## Gas Control Systems Solutions Overview

- Manifold Systems
- Control Panels
- HP/UHP Regulators
- Pressure Gauges
- Valves & Fittings



## Specialty Gas Manifolds

- Specialty Gas Control Panels
- Specialty Gas Manifolds
- Terminal Gas Control Panels
- Other Control Systems
- Accessories



## Ultra High Purity

- U Series Regulators
- DV Series Valves
- Pressure Gauges
- Face Seal Fittings
- Weld Fittings
- Vacuum Generators



## Specialty Gas Regulators & Accessories

- General Purpose Forged Brass Regulators
- High Purity Brass Barstock Regulators
- High Purity Stainless Steel Barstock Regulators
- Accessories



## Tube Fittings

- Male Connectors
- Male Elbows
- Male Adapters
- Female Connectors
- Female Elbows
- Unions
- Reducing unions



## F Series Filters

- Inline Filters
- T-type Filters

---

Please contact us for any questions about catalogs.

- Request Catalogs
- Register an account to view / download pdf catalogs. (Register Online)

---

To view our full line of Specialty Gas Products please visit us online at [www.genstartech.com](http://www.genstartech.com)



GENSTAR TECHNOLOGIES COMPANY INC.  
4525 Edison Ave, Chino, CA 91710  
Tel: 909.606.2726  
Fax: 909.606.6485  
[www.genstartech.com](http://www.genstartech.com)



GENTEC (SHANGHAI) CORPORATION  
No.499 Wenji Rd.Songjiang District. Shanghai 201616, P.R.C.  
TEL: +86 21 67727722  
FAX: +86 21 67727754  
[www.gentec.com](http://www.gentec.com)

